

# LONGS PEAK WATER DISTRICT

## DISTRICT SPECIFICATION DETAIL DRAWING

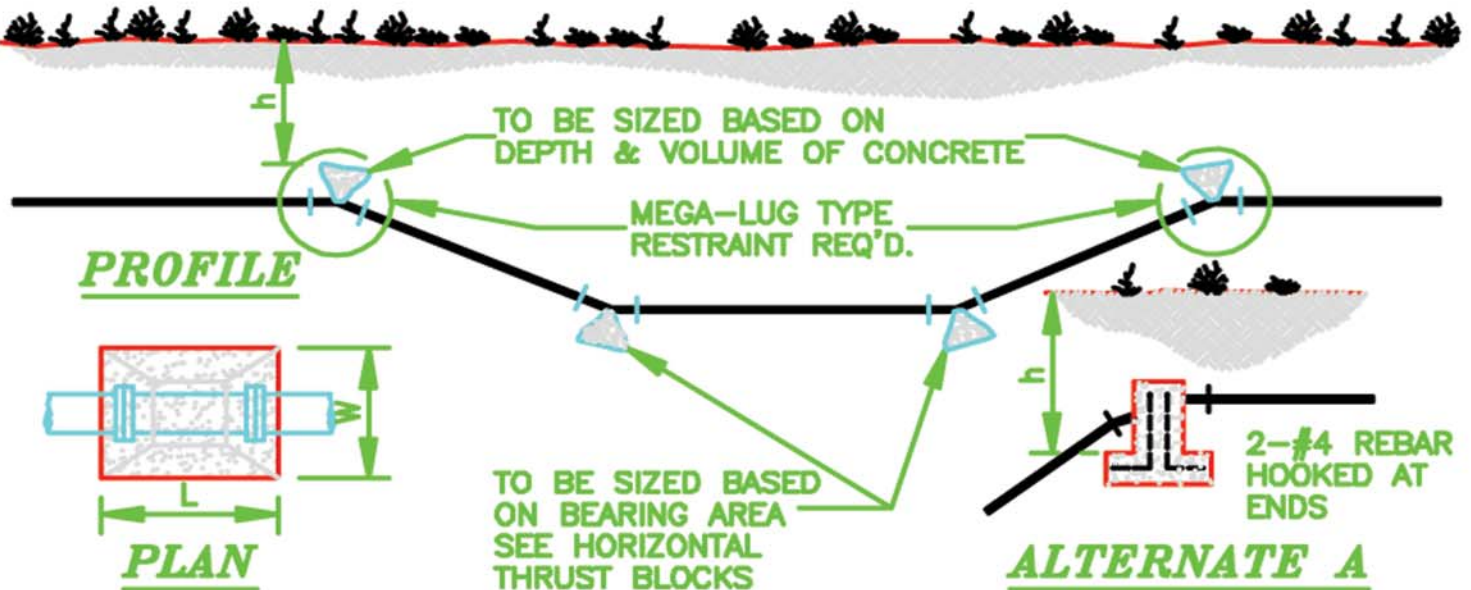

### NOTE:

ALL FITTINGS MUST BE WRAPPED WITH POLYETHYLENE TO PREVENT CONCRETE FROM ADHEARING TO BOLTS OR PIPE.

### REQUIRED C.Y. CONCRETE

SIZE	11 1/4" BEND	22 1/2' BEND	45' BEND
6"	0.4-W <sub>S</sub>	0.7-W <sub>S</sub>	1.2-W <sub>S</sub>
8"	0.6-W <sub>S</sub>	1.2-W <sub>S</sub>	2.2-W <sub>S</sub>
10"	1.0-W <sub>S</sub>	1.9-W <sub>S</sub>	3.4-W <sub>S</sub>
12"	1.4-W <sub>S</sub>	2.7-W <sub>S</sub>	4.9-W <sub>S</sub>
16"	2.4-W <sub>S</sub>	7.0-W <sub>S</sub>	8.8-W <sub>S</sub>
20"	3.8-W <sub>S</sub>	7.4-W <sub>S</sub>	13.7-W <sub>S</sub>
24"	5.5-W <sub>S</sub>	10.7-W <sub>S</sub>	19.7-W <sub>S</sub>
30"	8.5-W <sub>S</sub>	16.7-W <sub>S</sub>	30.9-W <sub>S</sub>
36"	12.3-W <sub>S</sub>	24.0-W <sub>S</sub>	44.4-W <sub>S</sub>

W<sub>S</sub> = WEIGHT OF SOIL EXPRESSED AS C.Y. CONCRETE EQUIVALENT

W<sub>S</sub> = W'xL'xh'x0.03

## VERTICAL THRUST BLOCK DETAIL

SCALE: NONE

REV. 1-1-06